

DESIGN-BUILD INSTITUTE OF AMERICA CALL FOR ENTRIES

DEADLINE: MARCH 4, 2022

2022 16TH ANNUAL Design-Build Awards Competition

Submissions are due:
March 4, 2022

Awards will be presented:
2022 Awards Program
Napa Meritage Resort
August 25, 2022

Sponsorships: www.dbiawpr.org



CALL FOR ENTRIES

WESTERN PACIFIC REGION 2022 DESIGN-BUILD AWARDS

OBJECTIVE

To acknowledge the most outstanding design-build projects in the Western Pacific Region area by promoting and recognizing the use and efficiency of design-build as a project delivery method.

CalTech Chen Neuroscience
Research Building ▶

2021 Project of the Year & Design
Excellence Award Recipient
California Institute of Technology
Hensel Phelps | SmithGroup | KPFF| AEI
Saiful Bouquet | Spurlock | TK1SC

The Competition

This year marks the Western Pacific Region's 16th Annual Design-Build awards competition!

To be considered for a Regional Design-Build Award, projects must demonstrate successful application of 2-build best practices as defined by the DBIA Design-Build Manual of Practice. These include: early integration of key team members during the proposal process via a proposal charrette or other collaborative outreach effort and close coordination between design and construction team members from the design development stage through field construction.

The acceptance of single-entity risk is a defining feature of design-build project delivery and winning submissions must be carried out under a DBIA or other single-responsibility contract. Only projects completed on time, on budget, and without litigation will be considered for an award. Projects are honored for design and construction that meets or exceeds owner expectations.

The formal Western Pacific Region's Design-Build Awards will be made during the Design-Build Awards program on Thursday, August 25, 2022 at Napa Meritage Resort in Napa, CA.

Eligibility

Eligible projects are located in California, Nevada, Hawaii, and Arizona. All design-build projects completed within the three years prior to January 1, 2022 are eligible.

Projects may be submitted for the Western Pacific Region Design-Build Awards no more than in two different calendar year competitions (excluding projects that already won a WPR award).

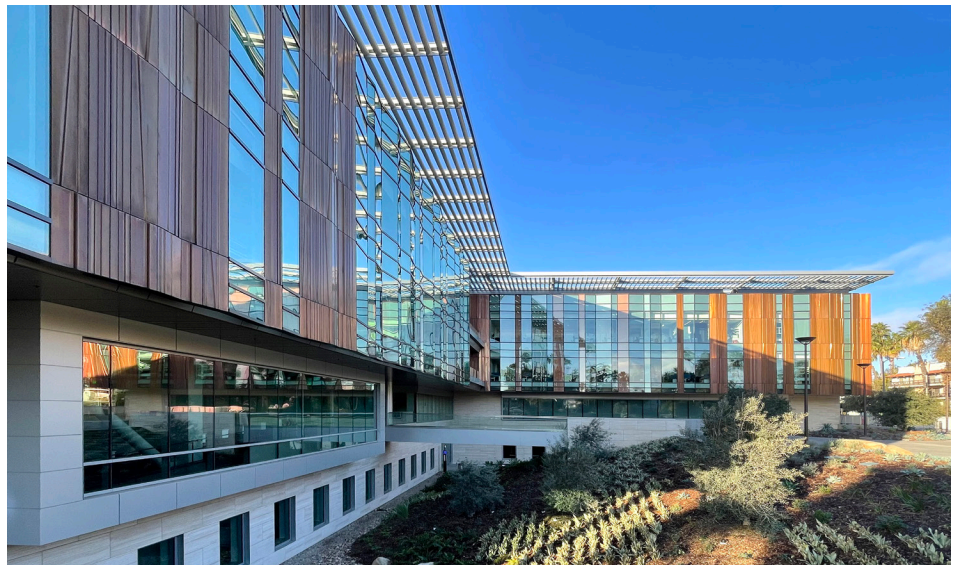

CALL FOR ENTRIES

WESTERN PACIFIC REGION 2022 DESIGN-BUILD AWARDS

Projects must be delivered under a single-source contract between the owner/user and the design-builder or the design-build team what was considered “at risk” for both cost and schedule. Eligibility is not based on the use of a DBIA contract document; any single-source contracted project meets this criterion.

All qualified teams are encouraged to submit entries. DBIA membership is not an award criterion.

AWARDS

Awards will be given at the discretion of the judges at the following levels:

Award of Merit

Excellent implementation of design-build techniques meeting or exceeding the owner’s expectations. One or more awards may be given at this level.

Award of Distinction

Successful analysis of design-build strategies resulting in a unique application of teaming to exceed the owner’s needs. One or more awards may be given at this level.

Regional Excellence

Exemplify the principles of interdisciplinary teamwork, innovation and problem solving. “Break new ground” in their approach and accomplishments.

Project of the Year

Chosen from all categories, one project will be awarded the top award of the entire program.

Design Excellence

Honors projects that achieve an owner’s overall aesthetic and functional vision through outstanding design.

Award of Excellence for Lean in Design-Build

Optional submittal category for Lean in Design-Build. Lean is increasingly being used in design-build project delivery and naturally supports and builds on the collaborative environment necessary for successful design-build. The winning team will successfully demonstrate integration and implementation of Lean approaches, tools, and techniques to create a collaborative environment and culture of continuous improvement aimed at value to the customer and elimination of waste.

Also submit your project in the National Awards Competition. Remember: Western Pacific Region requirements are *similar* to the National Awards Program, but have significant variation in requirements. Refer to www.DBIA.org for information regarding the National Competition.



Casa Roble High School Student Union & Admin Building ▲

2021 Regional Award Winner

San Juan Unified School District | Flint Builders, Inc.
JK Architecture Engineering | Vanir | Miyamoto International
Intech Mechanical | The Engineering Enterprise | Redwood Electric
Siegfried Engineering | Roach+Campbell | Terracon

CALL FOR ENTRIES

WESTERN PACIFIC REGION 2022 DESIGN-BUILD AWARDS

Submission Format

The design-build entity should be involved in the preparation of the submission. All entries must be received by **March 4, 2022**. Responses must be in the same order as requested, all questions answered completely and clearly, and submitted in the required format.

The entry fee for each submission is \$350 for DBIA-Western Pacific Region members, and \$500 for non-members. Please register on-line to submit the entry fee. The link for entry fee can be found on the DBIA-WPR Events page at: www.dbiawpr.org/news-events/awards/

Visit www.dbiawpr.org/membership to join and take advantage of the savings!

PAPERLESS

Submissions must be provided in the following format:

- One PDF format submission document titled with the project name.
- The PDF document must be complete and be organized with sections as directed in the following instructions.
- Provide page numbers in the lower right hand footer.
- All pages in the submission should be 8 ½" X 11" sized in portrait orientation. Minimum 10 point font.
- In addition to incorporating photographs into section 3 of the response, also provide separate, high resolution photograph files.

Provide all required files electronically to:

Committee Chair:

Jennie Gonzalez, Business Development Manager

Southland Industries

jegonzalez@enviseco.com

714-943-0150

***Flash drive submissions must be coordinated with Jennie prior to mailing.**

SUBMISSION REQUIREMENTS

Cover Letter - limit one page. Include:

- Project Name:
- Owner Name:
- Design/Builder Name:
- Architect Name:
- Key Design-Build Team member firms (to be listed on the presentation during the awards banquet):
- Submission Contact Information (Firm/Contact Name, Phone & Email):

If selected for an award, list the company name(s) to be engraved on the trophy (limit 3 lines):

Tab 1 – Why this Project Should Win a Design-Build Award - Maximum of 2 pages (25 points)

Provide a narrative description of the project (i.e. size, location, etc.), the project goals, the challenges and constraints of the project, the owner's design objectives, and the team's efforts to realize them.

Tab 2 – Design Excellence - Maximum of 2 page (20 points)

Describe the owner's criteria for design excellence and how it was achieved by the team. Client criteria for design excellence could include such elements as: embracing the client's values and transforming organizational performance; improving the site; advancing innovation in building materials and systems; providing a visual/aesthetic contribution to the community; and/or achieving the highest level of sustainability.

Please include a space plan with your submission (does not count towards page limit).

Tab 3 – Photographs – Please provide seven to ten images in the submission pdf, and provide them in separate, high-resolution .jpg files. Both "in-progress" and completed project photos are highly encouraged.

Applicants are responsible for obtaining the rights from their photographer to reprint the photographs without limitations. Ownership of a physical photo is not sufficient. Photographers normally retain the copyright of photos, so applicants should ensure that they have permission to copy and send photos to DBIA for use without limitations. Professional photographers must be credited. Any liability for copyright violation shall be borne solely by the applicant.

CALL FOR ENTRIES

WESTERN PACIFIC REGION 2022 DESIGN-BUILD AWARDS

Tab 4 - Teaming - Maximum of 1 page (20 points)

What methods or approaches were employed to engage and interact “as one team” collaboratively throughout the design AND construction phases of the project?

Describe the owner’s procurement process and how it encouraged collaboration and engagement.

Describe how the owner, various client stakeholders, and end users were engaged as part of the team throughout the design and decision making process.

Tab 5 – Schedule and Cost Performance - Maximum of 2 pages (25 points)

Complete the Table below:

	Contracted	Actual	Explain Any Variation
Start Date			
Completion Date			
Project Cost			

Describe the approach and methods that were employed to facilitate and manage the “design to budget” throughout the design phase of the project. Give examples of how you provided the owner with the “best value for dollar spent”.

Describe how the design-build team met required schedule dates. If there were any changes, explain why. Describe any special or unusual challenges involved in meeting the schedule.

Tab 6 – Safety - Maximum of 1 page (10 points)

Describe any specialized or innovative safety and health programs and training used specifically for this project.

Include a table that lists:

Total hours worked on the project	
Number of Recordable Incidents	
Number of Lost Time Incidents	

Please include subcontracted hours when available

Submissions must disclose if there were fatalities on the project, and if so, provide a full explanation of the circumstances.

Lean In Design-Build (Optional Awards Category)

Maximum of 1 page; include as the last section of your submittal

Describe how your team successfully implemented Lean Design and Construction approaches, tools, and techniques across the entire project team and throughout the project.

Describe how the process created value for the owner, promoted collaboration between team members, and eliminated waste.

Questions?

Send questions to Jennie Gonzalez: jegonzalez@enviseco.com.

GOOD LUCK!

Judging

A jury of industry experts will evaluate project submissions primarily on successful achievement of the owner’s project goals through implementation of design-build best practices as defined by DBIA’s Design-Build Manual of Practice. Submissions should highlight the design-build team’s collaborative efforts to add value to the project. DBIA best practices include but are not limited to early integration of key team members during the proposal process via charrette or other collaborative outreach effort; collocation of project team members to encourage coordination between design and construction team members; and the use of incentives within the project team.

Owner’s design objectives and the team’s efforts to realize them should be addressed in all submissions.



DESIGN-BUILD INSTITUTE OF AMERICA CALL FOR ENTRIES

2022

16TH ANNUAL

Design-Build Awards Competition

Submissions are due:
March 4, 2022

Awards will be presented:
2022 Awards Program
Napa Meritage Resort
August 25, 2022

Sponsorships: www.dbiawpr.org



CALL FOR ENTRIES

WESTERN PACIFIC REGION 2022 LEADERSHIP AWARDS

OBJECTIVE

To recognize individuals who have demonstrated leadership in the advancement of best design-build practices and of design-build as the project delivery method of choice.



CALL FOR ENTRIES

WESTERN PACIFIC REGION 2022 LEADERSHIP AWARDS

Categories

Awards may be presented in the following categories.

Owner

- *Public Sector*
- *Private Sector*

Industry Professional

Including, but not limited to, architect, engineer, specialty contractor, and attorney

Legislator

- *State Legislator*
- *Local Legislator*

Full-time Faculty

Includes full-time faculty at accredited institutions of higher learning

Student

Enrolled in an academic program, either undergraduate or graduate, during the 2021-2022 academic semesters



CALL FOR ENTRIES

WESTERN PACIFIC REGION 2022 LEADERSHIP AWARDS

Successful
submissions will
be notified
by May 2022

Award winners
will be recognized
at the 2022
Annual Design-
Build Awards
Banquet on
August 25, 2022
at the
Napa Meritage
Resort

Sponsorships:
www.dbiawpr.org

Sponsorship and
ticket information
can be found at
dbiawpr.org/awards.

Category Criteria

Public and Private Sector Owner nominees are judged by the overall impact of their professional work. They are evaluated in terms of their achievements in furthering design-build as a delivery method as demonstrated in one or more of the following areas.

- A strong and well-documented commitment to design-build and single source responsibility contracting through repeated use.
- Use of design-build in a new application, such as D-BOT or D-BOM, a new project type, or the development and use of a new technology.
- Active participation on the design-build team by attending meetings and making decisions in a timely manner.
- A strong involvement in the design-build industry.
- Vocal and written advocacy of design-build and design-build best practices in the public sector.
- Commitment to the use of design-build best practices.

Industry Professional nominees are judged by the overall impact of their professional work. They are evaluated in terms of their achievements in advancing design-build as a delivery method as demonstrated in one or more of the following areas.

- A strong and well-documented commitment to design-build and single source responsibility contracting through repeated use.
- Use of design-build in a new application, such as D-BOT or D-BOM, a new project type or the development and use of a new technology.
- Active participation on the design-build team by attending meetings and making decisions in a timely manner.
- A strong involvement in the design-build industry.
- Vocal and written advocacy of design-build and design-build best practices in the private sector.
- Commitment to the use of design-build best practices.

State & Local Legislator nominees are judged by the overall impact of their legislative careers. They are evaluated in terms of their achievements in furthering design-build as a delivery method as demonstrated in one or more of the following areas.

- A strong and well-documented commitment to alternate delivery strategies, including design-build project delivery.
- Sponsorship or co-sponsorship of design-build enabling legislation on the state or local level.
- Vocal and written advocacy of design-build and design-build best practices for use in public agencies or departments.

CALL FOR ENTRIES

WESTERN PACIFIC REGION 2022 LEADERSHIP AWARDS

Faculty nominees are judged by the overall impact of their research and teaching careers. They are evaluated in terms of their achievements in furthering design-build as a delivery method as demonstrated in one or more of the following areas.

- Development of a series of courses or a curriculum on design-build.
- Research and development in the promotion of design-build and design-build best practices.
- Involvement in the design-build industry.
- Mentoring students in design-build.
- Encouragement and active involvement in DBIA student chapters.
- Vocal and written advocacy of design-build.

Student nominees are judged by the overall direction and impact of their student careers. They are evaluated in terms of their achievements in furthering design-build as a delivery method as demonstrated in one or more of the following areas.

- Enrollment in a series of courses or a curriculum on design-build.
- Contact with and mentoring by design-build professionals.
- Articulation of design-build issues to other students and faculty.
- Completion of papers, theses, or dissertations on items relating to design-build.
- Participation in design-build competitions.
- Participation in national or regional DBIA events (conferences, seminars, etc.).
- Founding/leadership role in DBIA student chapter*.

* Only applicable if a DBIA student chapter currently exists on campus



CALL FOR ENTRIES

WESTERN PACIFIC REGION 2022 LEADERSHIP AWARDS

**All Submissions
must be received by
March 4, 2022.**

Nominations

There is no entry fee for nominating an individual for the Design-Build Leadership Awards. Nominations must be formatted in Microsoft Word or PDF format and submitted **via email** to Jennie Gonzalez at jegonzalez@enviseco.com. "2022 Leadership Awards" should be in the subject line of the email. All nominations must be received by DBIA-WPR no later than March 4, 2022.

In the nomination submission, include the following:

Cover Page

The text "2022 Distinguished Leadership Awards"

Nominee's name, position, company/organization, and contact information (mailing address, email, and phone number(s)). If the nominee is a student, please be sure to include where he/she may be reached during the summer months.

Contact information of the person submitting the nomination (name, organization, mailing address, email, and phone number(s)).

Include the following:

Include "2022 Distinguished Leadership Awards – Nominee's name, organization, and category" as the header for each page. Provide a detailed description answering how the nominee meets the award criteria (8 1/2 x 11, portrait orientation, minimum 10 font). Visual aids may be included if supportive of the nomination. They should not exceed 8.5" x 11" in size and should be included within the nomination document. Videocassettes, CDs, and DVDs will not be accepted.

Signed Agreement

The following statement must be included at the end of the nomination:

"I understand that the contents of this entry become the property of DBIA and will not be returned. I further understand that DBIA shall have the right to make all text and photos, if any, available for publication without compensation, real or implied, and without claim by nominees against the jury, DBIA or its staff, or individual DBIA members." (Sign and scan or include either an electronic signature or your initials, and the date, as agreement to this statement.)

Signature

Printed Name

Date